



Quality, Reliability, Life

# Submersible Drainage Pump



### Applications

- Civil Engineering
- Industrial & Residential Building sites
- Basements or other utility pits
- Rain water & Mud Water

### Application limits

- Liquid Temperature: up to 40°C
- Ambient temperature: up to 40°C
- Liquid PH value: 6.5 to 8.5
- Minimum water level: 1 mm
- Max. immersion depth: 10 meters

### Performance Range

- Flow: up to 18 m<sup>3</sup>/h
- Head: up to 14.5 meters
- Speed: 2900 RPM
- Power: 0.55-0.75 Kw

### Motor Details

- 2 Pole Motor
- Insulation class – F
- Motor protection: Built in
- Protection class: IP68
- Voltage: 220-240v, 50Hz
- Cable length: 8 meters
- Duty: S1

### Installation and use

PSDP series pump is a portable submersible residue drainage pump. There is a one-way valve in the bottom inlet to prevent the water in the pipeline from flowing back. The minimum water level can be pumped to 1mm.

PSDP pump adopts lightweight design. The small outer diameter allows it to be used in an 8-inch well. The components of PSDP series are made of wear-resistant rubber and ductile iron, which is with excellent durability. The water is sucked from the bottom and discharged from the top through the inner layer between the motor case and the water jacket, which provides the highest cooling efficiency for the motor and allows continuous operation at low water level. A large gap is between the semi open impeller and the pump body, so the impeller will not easily be stuck by mud or sand. The hose coupling could be installed vertically or obliquely to prevent the soft hose pipe from folding or bending.

### Pump Selection Chart

| Model   | Power |      | Voltage<br>(50Hz) | Speed<br>(RPM) | Outlet<br>(inch) | Max.<br>Flow<br>(LPM) | Max.<br>Head<br>(meter) | Net<br>Weight<br>(Kg) |
|---------|-------|------|-------------------|----------------|------------------|-----------------------|-------------------------|-----------------------|
|         | KW    | HP   |                   |                |                  |                       |                         |                       |
| PSDP550 | 0.55  | 0.75 | 220-240v          | 2900           | 1"               | 125                   | 11                      | 12.7                  |
| PSDP750 | 0.75  | 1.0  |                   |                | 2"               | 300                   | 14.5                    | 15.1                  |

### Pump Dimension

| Model   | Dimension in mm |     |     |     |     |    |
|---------|-----------------|-----|-----|-----|-----|----|
|         | Ø D             | A   | B   | D   | H   | W1 |
| PSDP550 | 25              | 173 | 325 | 205 | 358 | 1  |
| PSDP750 | 50              | 173 | 365 | 205 | 398 | 1  |

## G.A Drawing

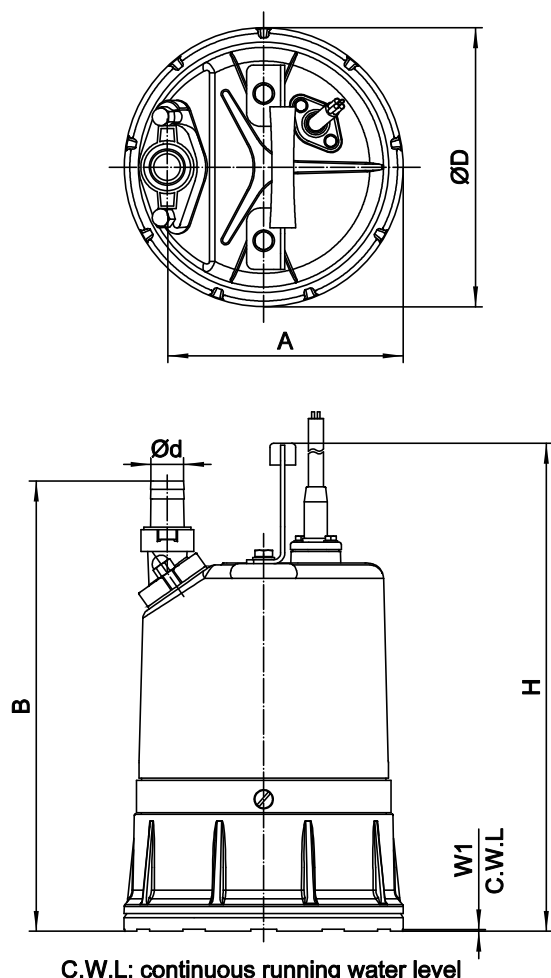

## Suctional View

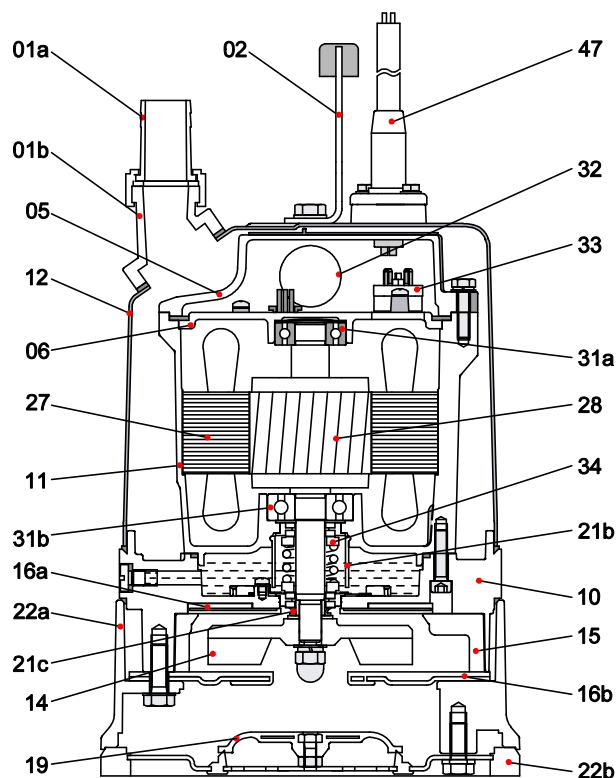

## Contraction of Material (MOC)

| Item No. | Name of Parts           | Material             | Item No. | Name of Parts   | Material                   |
|----------|-------------------------|----------------------|----------|-----------------|----------------------------|
| 01       | Hose Coupling           | Aluminum die casting | 21a      | Oil riser       | NBR                        |
| 01b      | Hose Coupling           | Aluminum die casting | 21b      | Sand guard      | LDPE                       |
| 02       | Handle                  | Rubber & Steel       | 22a      | Stainer         | Aluminum die casting       |
| 05       | Upper cover             | Aluminum die casting | 22b      | Stainer         | NBR & Steel                |
| 06       | Up-Bearing house        | Cast Iron            | 27       | Stator          |                            |
| 10       | Seal Housing            | Aluminum die casting | 28       | Rotor           | Shaft SS420                |
| 11       | Motor body              | Aluminum die casting | 31a      | Bearing         | Ball bearing               |
| 12       | Pump body/ Outer casing | Steel                | 31b      | Bearing         | Ball bearing               |
| 14       | Impeller                | Ductile Iron         | 32       | Capacitor       |                            |
| 15       | Diffuser                | NBR                  | 33       | Motor protector |                            |
| 16a      | Plate                   | NBR & Steel          | 34       | Mechanical seal | Ceramic-sic/carbon-ceramic |
| 16b      | Inlet plate             | NBR & Steel          | 47       | Cable           | Copper & PVC               |
| 19       | Check valve             | NBR & Steel          |          |                 |                            |

### Pump Performance Chart

| Model   | Power |      | Q        | US GPM | 0    | 13.2 | 26.4 | 33   | 39.6 | 52.8 | 66  | 79.2 |
|---------|-------|------|----------|--------|------|------|------|------|------|------|-----|------|
|         |       |      |          | M³/H   | 0    | 3    | 6    | 7.5  | 9    | 12   | 15  | 18   |
|         | KW    | HP   |          | LPM    | 0    | 50   | 100  | 125  | 150  | 200  | 250 | 300  |
| PSDP550 | 0.55  | 0.75 | Head (m) |        | 11   | 9    | 6    | 4.5  |      |      |     |      |
| PSDP750 | 0.75  | 1.0  |          |        | 14.5 | 13.5 | 12   | 11.5 | 10.7 | 9    | 6   | 3    |

Pump Performance Curve PSDP550F & PSDP750F 2900RPM, 50Hz

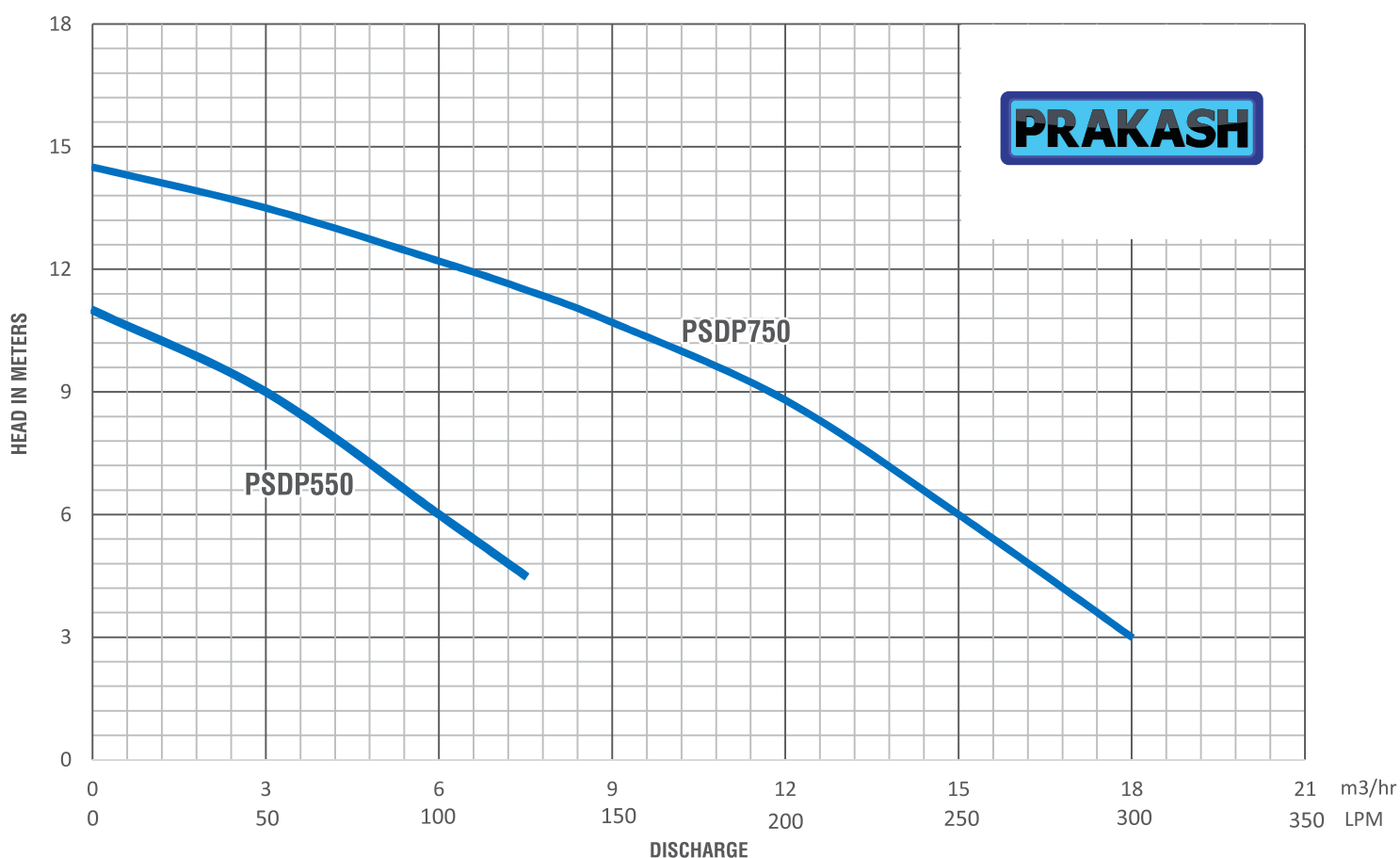

# PRAKASH

Office in India

## PRAKASH PUMP

Survey No. 479, Opp. Supreme Estate-1, Zak Kadadara Road, Vill. - Kadadara,  
Tal. Dahegam, Gandhinagar, Gujarat 382305 INDIA E-mail: [sale@prakashpump.com](mailto:sale@prakashpump.com)

Distributor Office for Middle East

## PRAKASH PUMP EST

P.O. Box: 20973 Industrial Area Al Ain (United Arab Emirates)  
Tel.: +971 3 7222733 Mob.: +971 50 6731283 E-mail: [sale@prakashpump.com](mailto:sale@prakashpump.com)

Distributor Office for Oman

## GLOBAL EQUIPMENT MATERIAL CO. LLC

P.O. Box. 227, Postal Code: 320 Nakhal Road, Barka (Sultanate of Oman)  
Tel.: +968 26883982 Mob.: +968 94584686 E-mail: [oman@prakashpump.com](mailto:oman@prakashpump.com)

Distributor Office for Saudi Arabia

## PRAKASH PUMP INDUSTRY

P.O. Box 14327, Bldg. 3616, Al Marwah 6447, Al Mishael Riyadh City, (Kingdoms of Saudi Arabia)  
Sulay Exit 18. Mobile: +966 539811109 Email: [saudi@prakashpump.com](mailto:saudi@prakashpump.com)

Factory Address

## PANJI ENGINEERING PVT LTD

Survey No. 479, Opp. Supreme Estate-1, Zak Kadadara Road, Vill. - Kadadara,  
Tal. Dahegam, Gandhinagar, Gujarat 382305 INDIA E-mail: [sale@prakashpump.com](mailto:sale@prakashpump.com)



To get  
Quotation by email



PRAKASHPUMPEST

These images given are only for illustration purpose  
for further details contact the sales team at  
[sale@prakashpump.com](mailto:sale@prakashpump.com) / [oman@prakashpump.com](mailto:oman@prakashpump.com)  
/ [saudi@prakashpump.com](mailto:saudi@prakashpump.com)



To get  
Website

